



CONQUER

PRIME

Carbon Hookless Clincher

DISC BRAKE MTB WHEELSET-BOOST SPACING

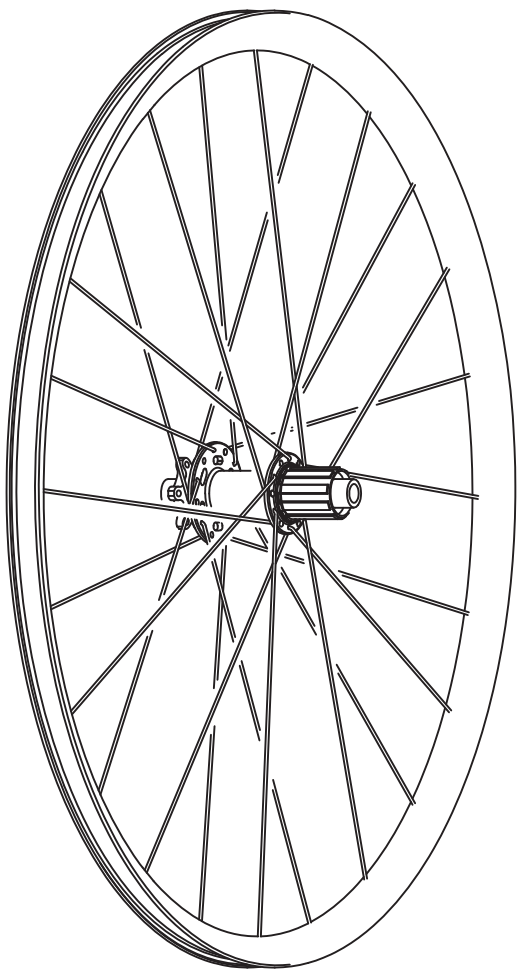
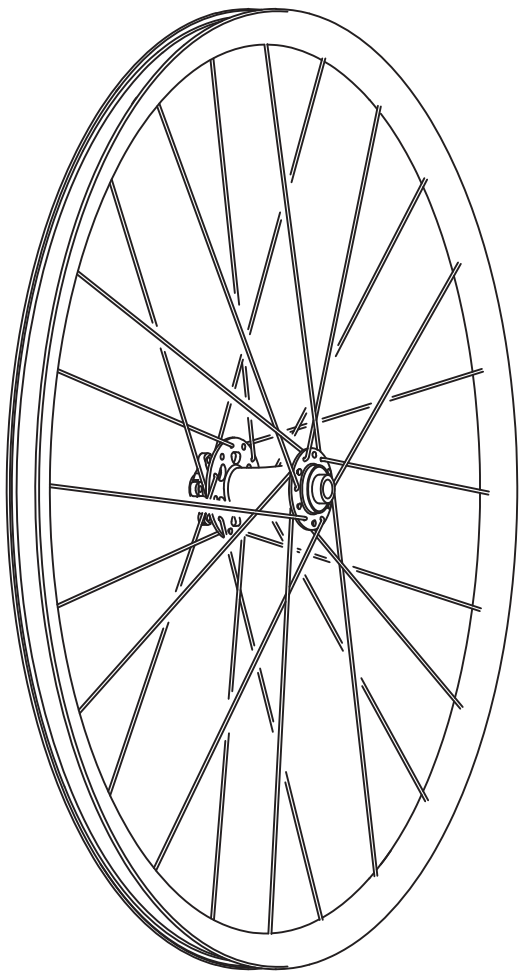

SPECIFICATION

RIM				HUB	SPOKE / NIPPLE	CASSETTE COMPATIBILITY	WHEEL MAXIMUM
Profile Depth	Internal Width	External Max Width	Recom'ed Tyre Size	TK4939 Hubset F-28H R-28H PREMIUM Bearing	Pillar PDB1416 Black Spoke	Shimano HG SRAM XD Micro Spline	Inflation Pressure 72psi (all sizes, with or without tube)
25mm	30mm	36mm	29"x2.1" - 3.0"		Alloy External Black Nipple		Rider Weight 100kg

WARNING

- 1. Over tensioning spokes and exceeding maximum inflation pressure could cause unseen damage. Note that overly inflated tyres don't necessarily have lower rolling resistance, and may have inferior traction!
- 2. Mounting clincher tyres on tubeless-ready rims could take more effort than on regular rims. Take great care not to damage any part of the rim with tyre lever! Applying mild soap water or tyre sealant on rim and tyre bead could make tyre installation easier.
- 3. Make sure your tyre-and-wheel combination meets ISO 4210-6 Safety Requirement regulation - there should always be a clearance no less than 4mm between the tyre and the frame, as well as other components such as brake caliper.
- 4. Failure to follow the conditions listed above may result in 3-year warranty being voided. Contact your local dealer or see the TOKEN website for details. -www.tokenproducts.com-

HUBS

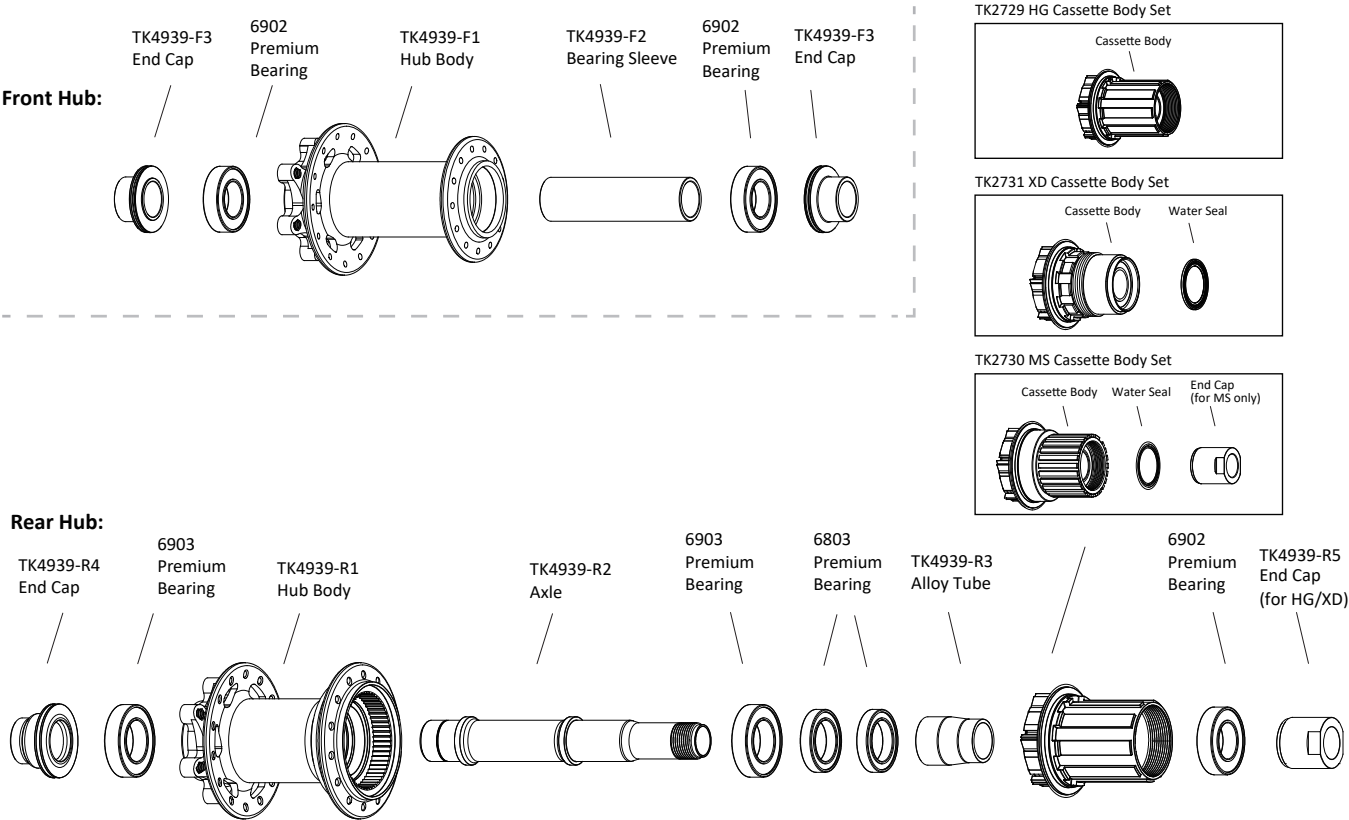

WHEEL BUILDING

RIM

BEARING

Spoke Information		Tension (kgf)	Size	Length (mm)	ERD (mm)	Front	Rear < SHIMANO >
Front	Drive Side (RH)	90~110	14G	286	590	6902*2	6902*1 6803*2 6903*2
	Non-Drive Side (LH)	100~120	14G	282			
Rear	Drive Side (RH)	110~130	14G	284			
	Non-Drive Side (LH)	75~95	14G	282			