

A-Box Headset

AERO Integrated Cable Routing System

Fully integrated cable routing for the best Aerodynamic, swift rotation and ultra smooth shifting performance.

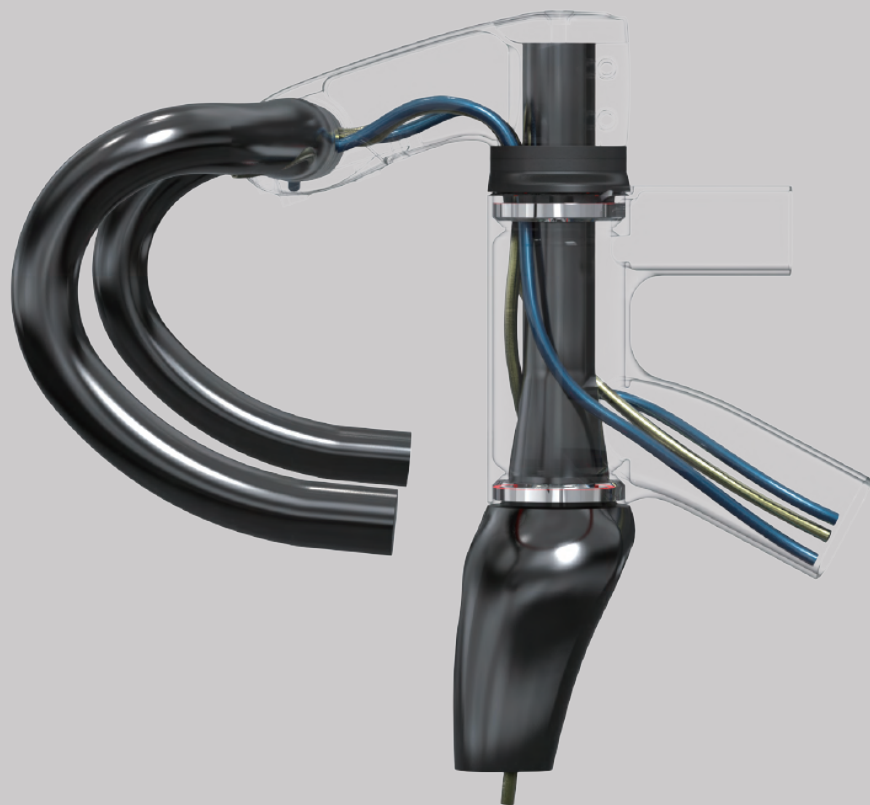

Speed Addict Spacer
5mm / 10mm
[by Order](#)



Top Cover



Top Cover Seal
OD52 / OD62
[by Order](#)



Micro Spacer



Star Compression Ring



Bearing Shield
[by Order](#)



Double Seals
Premium Bearing
45° or 36°
[by Order](#)



Upper Cup
Lower Cup
ZS or EC type
[by Order](#)



Double Seals
Premium Bearing
45° or 36°
[by Order](#)



Crown Race
45° or 36°
[by Order](#)





Stem: Integrated Cable Routing with Hole in the bottom
Bar: Integrated Cable Routing with Hole at Bar Center
Fork: Molded with Hole for Front Disc Brake Cable

A-BOX

IOKLIN frameworks



MMR BIKE



C-Box Headset

Semi-Integrated Cable Routing System with Cable Cover

Semi-integrated cable routing system with cable cover designed. The adjustable cover permits routing without removing the stem so that cockpit installations and upgrades can be done effortlessly.

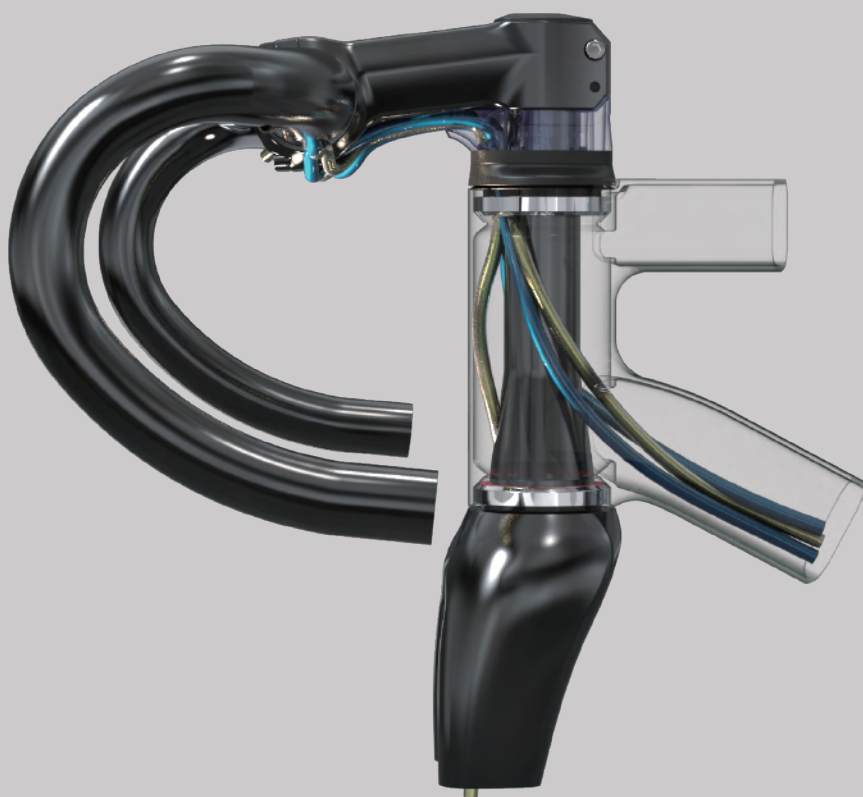

Bearing Shield For IS52 headtube.
Model: TK155-5

The Bearing Shield could be beneficial for Cable Box system when used in extreme conditions, protects the upper bearing from environment elements and sweat damage.

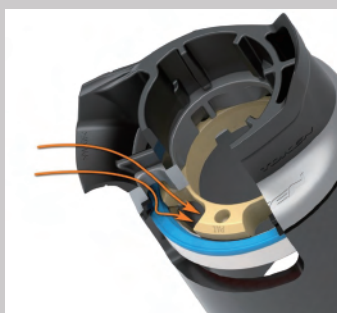

Cable Cover



Speed Addict Spacer
5mm / 10mm
[by Order](#)



Top Cover



Top Cover Seal
OD52 / OD62
[by Order](#)



Micro Spacer



Star Compression Ring



Bearing Shield
[by Order](#)



Double Seals
Premium Bearing
45° or 36°
[by Order](#)



Upper Cup
Lower Cup
ZS or EC type
[by Order](#)



Double Seals
Premium Bearing
45° or 36°
[by Order](#)



Crown Race
45° or 36°
[by Order](#)





Stem: Unique design with compatible shape to Cable Cover
 Cable Cover: Unique design with compatible shape to Stem
 Bar: Standard
 Fork: Molded with Hole for Front Disc Brake Cable

C-BOX

CEEPO - RINDO BIKE



LOOK - 765 OPTIMUM 2





A-BOX

AERO Integrated Cable Routing System



C-BOX

Semi-Integrated Cable Routing System with Cable Cover

TK155-4-P5
TK155-4-P10

SPEED-ADDICT Spacers (pair) for A-Box Headset
Available In 5mm and 10mm Height

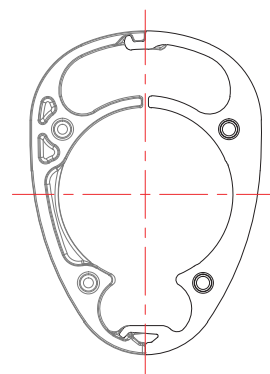
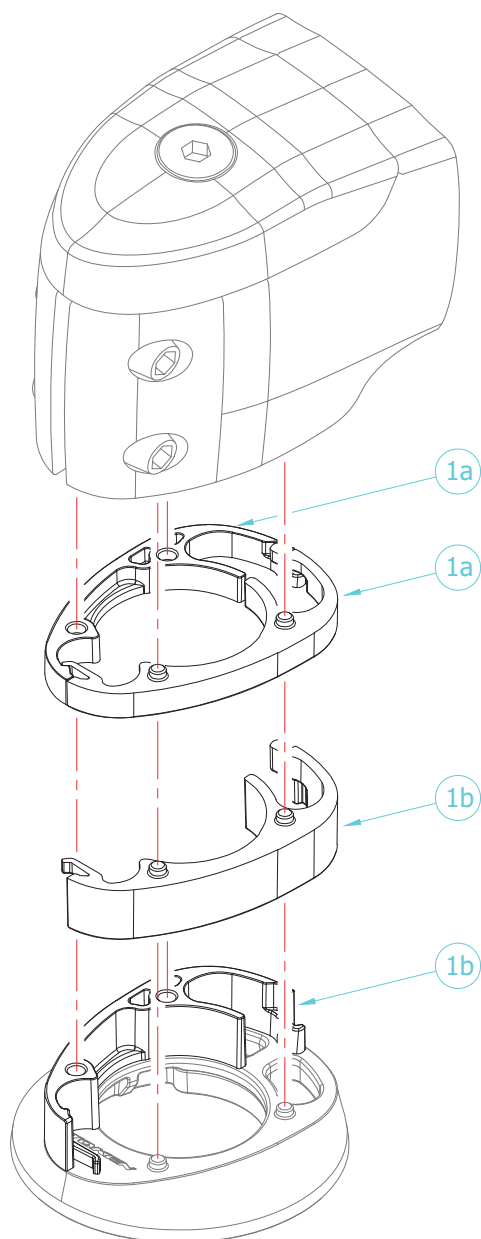

Designed for aerodynamic and quick adjustment.

- Pin-and-hole interface.
- Flip-flop design.
- Light weight composite material.

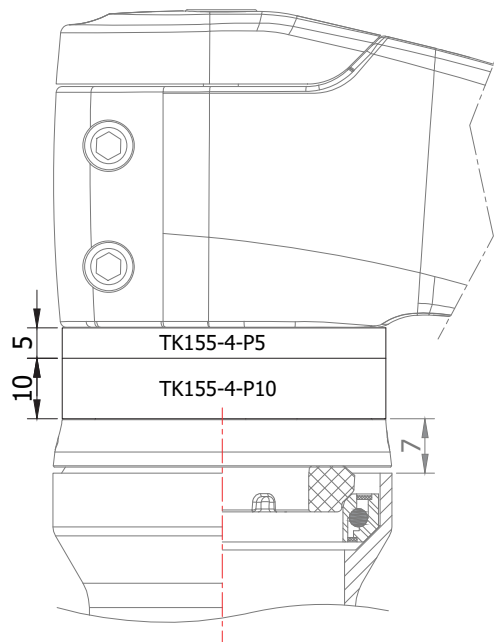

No.	Item	Material	Drawing	Q'ty
1a	Speed-Addict Spacer 5mm	Composite	TK155-4-P5	2
1b	Speed-Addict Spacer 10mm	Composite	TK155-4-P10	2
Unit: mm		Scale: 1.25:1	Version: A 2020.05.04	

TOKEN HEADSET TECHNICAL MANUAL

TK155 TK155P

A-Box Headset w/ Carbon Top Cover
(TK155P: With ① GF-Composite Top Cover TK155-2)

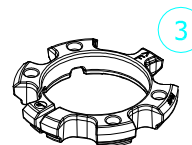
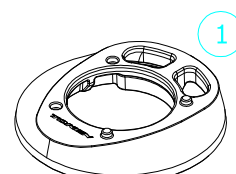
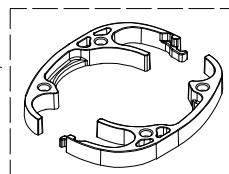
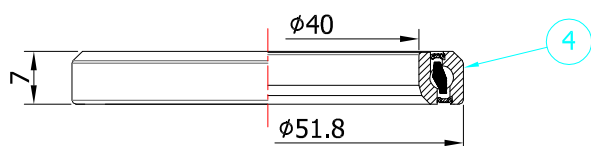
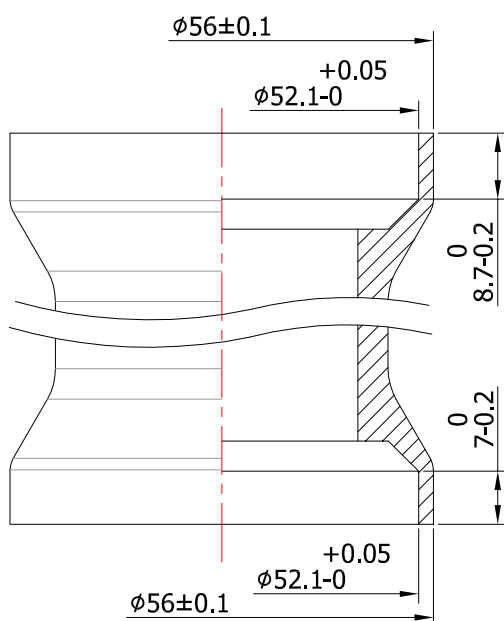
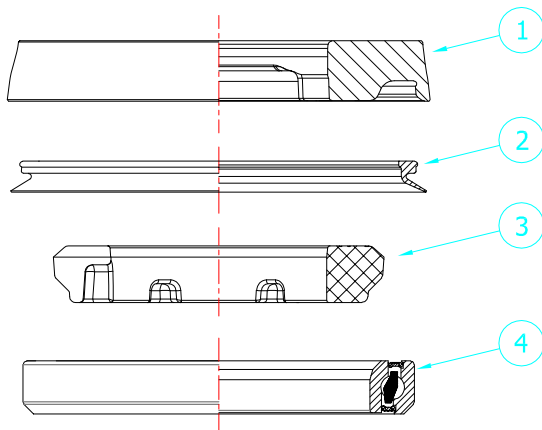
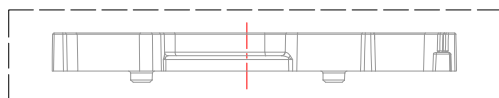

Spacers (Not Included)
Available in 5mm & 10mm

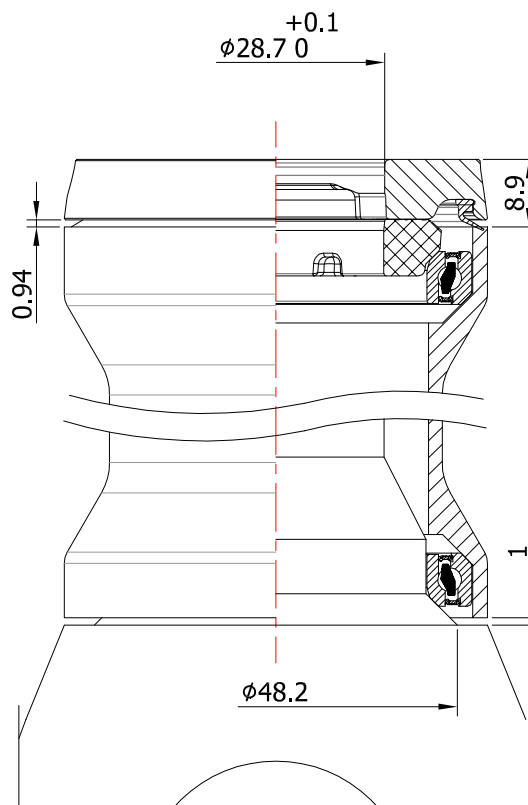

Stack Height: 8.9+1=9.9mm

SHIS code: IS52/28.6 | IS52/40

No.	Item	Material	Drawing	Q'ty
1	Top Cover	Carbon Composite	TK155-2C	1
2	Seal	NBR	TK155-1	1
3	Compression Ring	Composite	TK155-3	1
4	Premium Bearing	Steel	ACB52H7/4	2
Unit: mm		Scale: 1:1	Revision: F	
			2021.11.24	

TOKEN HEADSET TECHNICAL MANUAL

TK155-36 TK155P-36

A-Box Headset w/ Carbon Top Cover and 36°/45° Lower Bearing
(TK155P-36: With ① GF-Composite Top Cover TK155-2)

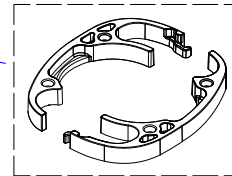
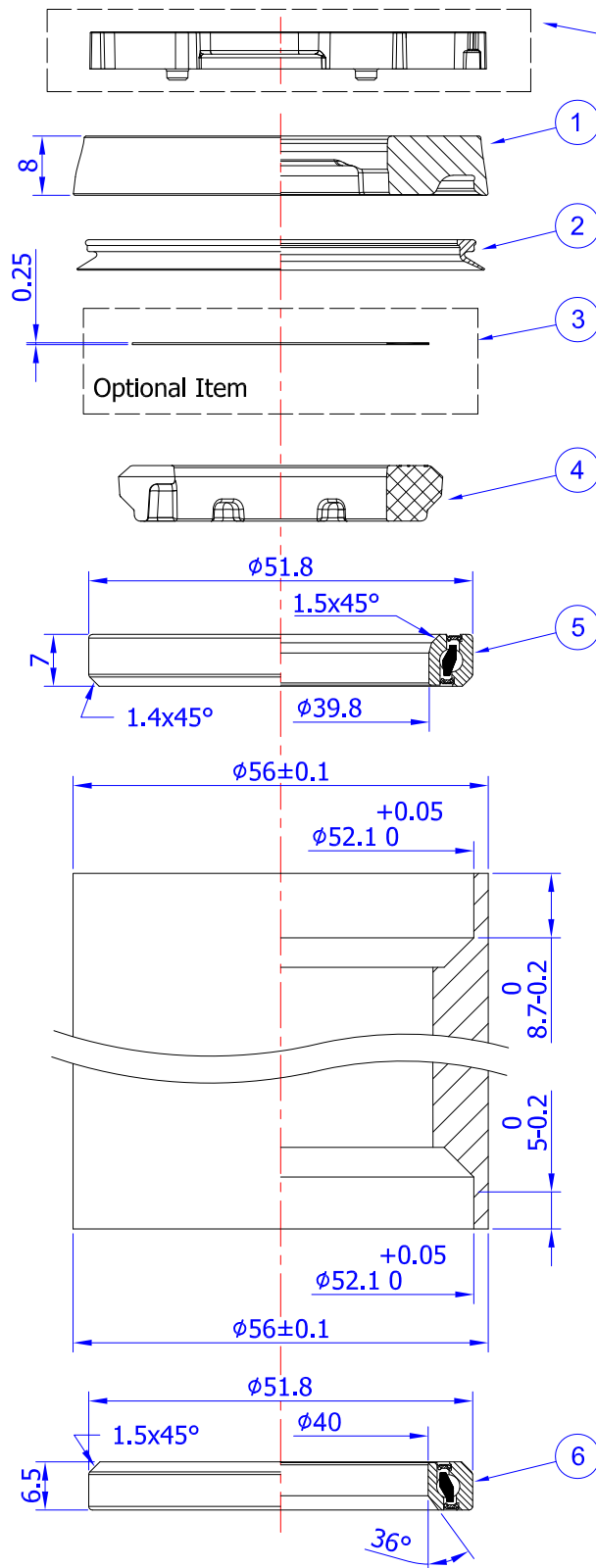

Spacers (Not Included)
Available in 5mm & 10mm

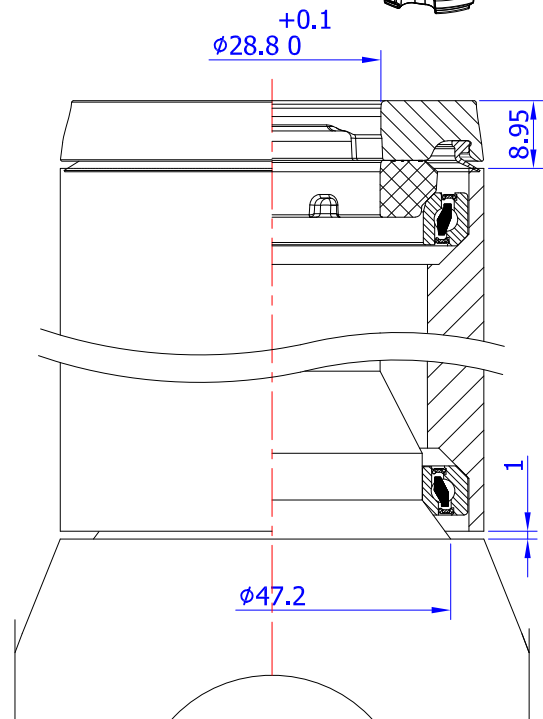
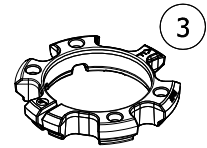
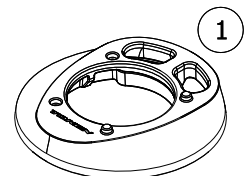

Stack Height: $8.9 + 1 = 9.9\text{mm}$

SHIS code: IS52/28.6 | IS52/40

No.	Item	Material	Drawing	Q'ty
1	Top Cover	Carbon Composite	TK155-2C	1
		PA+GF	TK155-2	
2	Seal	NBR	TK155-1	1
3	Micro Spacer	PET	CHS003	1
4	Compression Ring	Composite	TK155-3	1
5	Premium Bearing	Steel	ACB52H7/4	1
6	Premium Bearing	Steel	TK518H65	1
Unit: mm		Scale: 1:1	Revision: G	
			2023.07.13	

TK1556 TK1556P

A-Box Headset w/ Carbon Top Cover and Alloy Crown Race
(TK1556P: With ① GF-Composite Top Cover TK155-2)

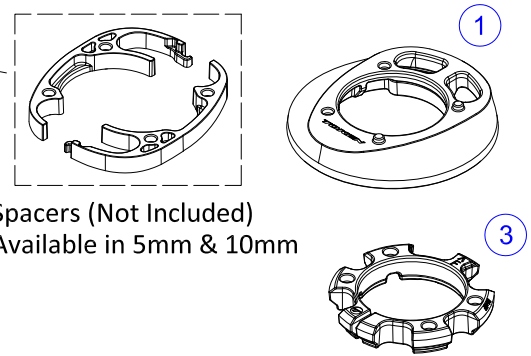
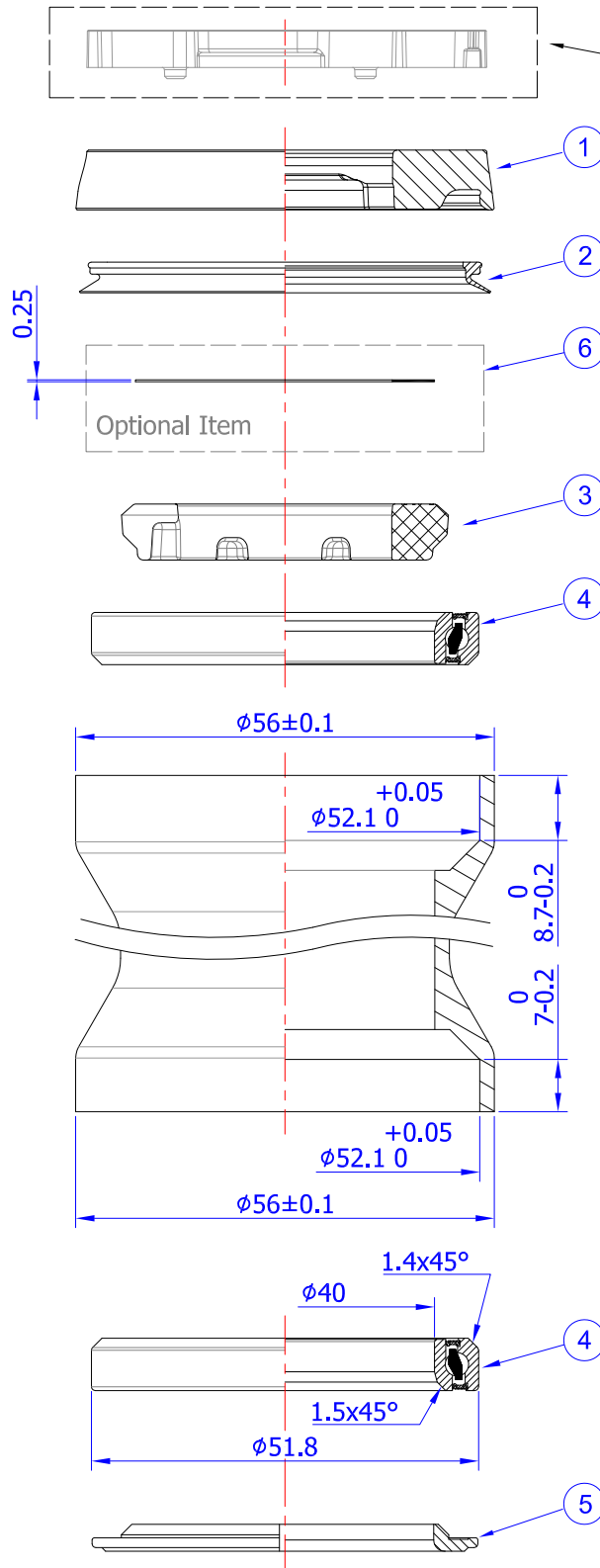

Spacers (Not Included)
Available in 5mm & 10mm

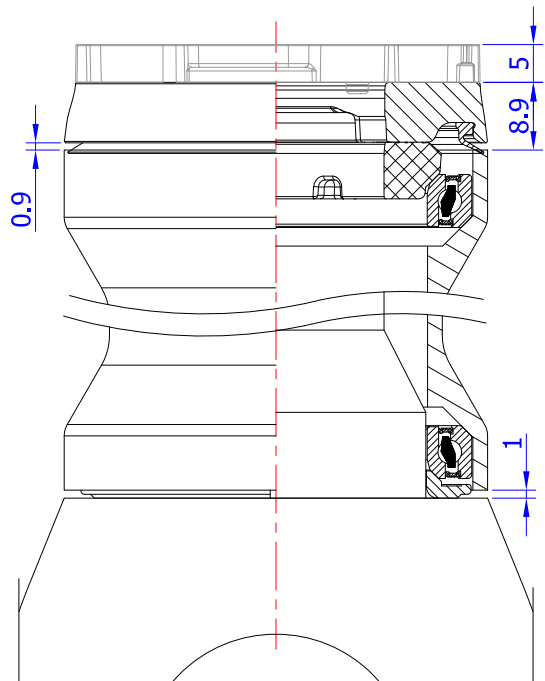

Stack Height: $8.9 + 1 = 9.9\text{mm}$

SHIS code: IS52/28.6 | IS52/40

No.	Item	Material	Drawing	Q'ty
1	Top Cover	PA+GF	TK155-2	1
		Carbon Composite	TK155-2C	
2	Seal	NBR	TK155-1	1
3	Compression Ring	Composite	TK155-3	1
4	Premium Bearing	Steel	ACB52H7/4	2
5	Crown Race	Alloy	TK1556-6	1
6	Micro Spacer	PET	CHS003	1
Unit: mm		Scale: 1:1		Revision: D 2023.08.29

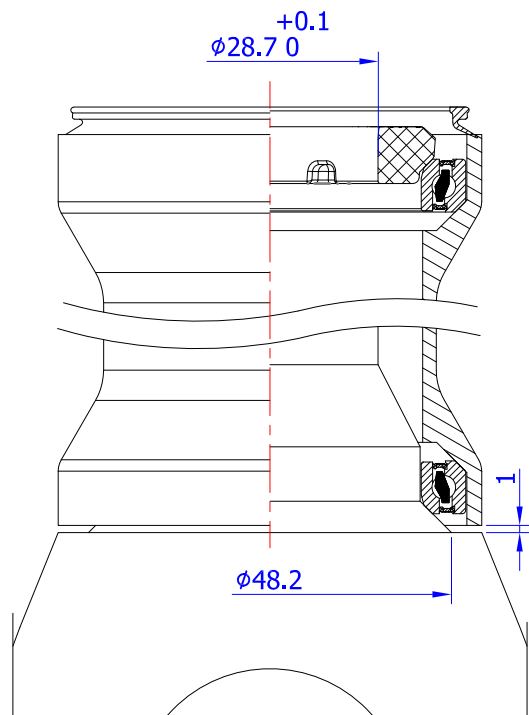
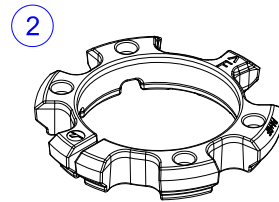
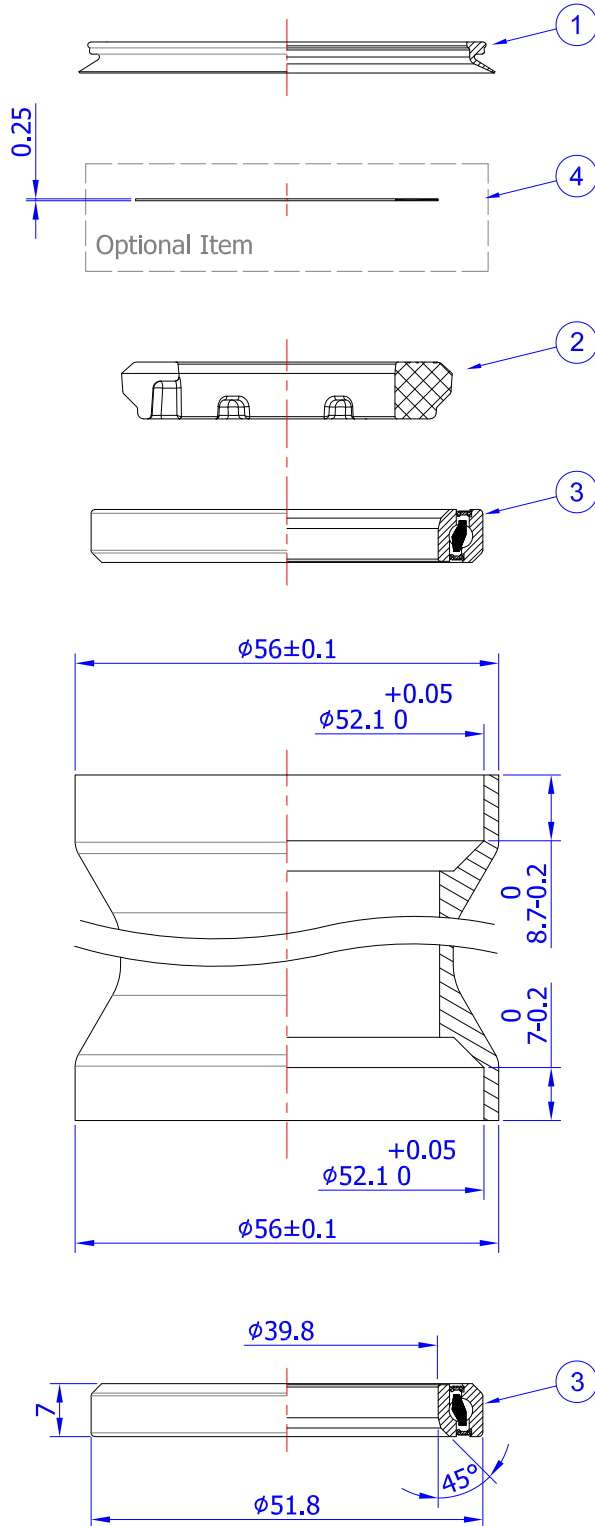
TK155-KIT
CABLE BOX Headset Bearing Kit

SHIS code: IS52/28.6 | IS52/40

No.	Item	Material	Drawing	Q'ty
1	Seal	NBR	TK155-1	1
2	Compression Ring	Composite	TK155-3	1
3	Premium Bearing	Steel	ACB52H7/4	2
4	Micro Spacer	PET	CHS003	1
Unit: mm		Scale: 1:1	Version: E	
			2023.08.30	

TK155-36-KIT

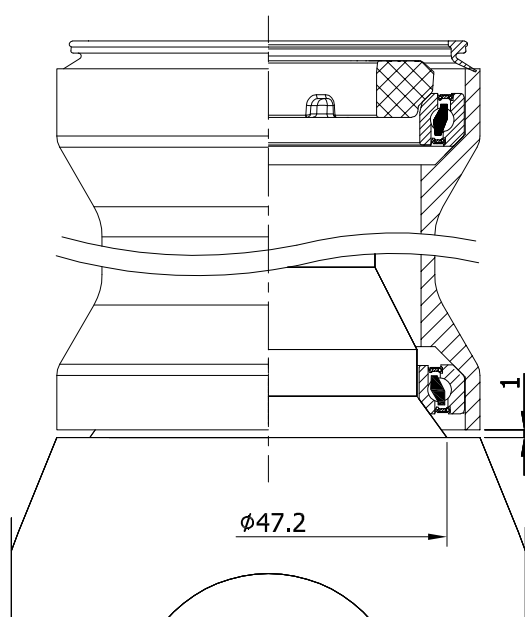
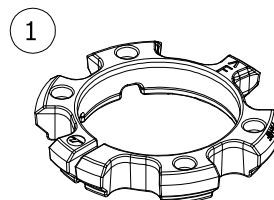
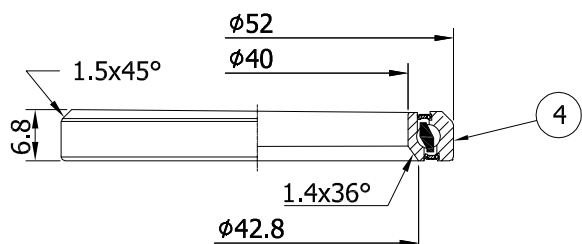
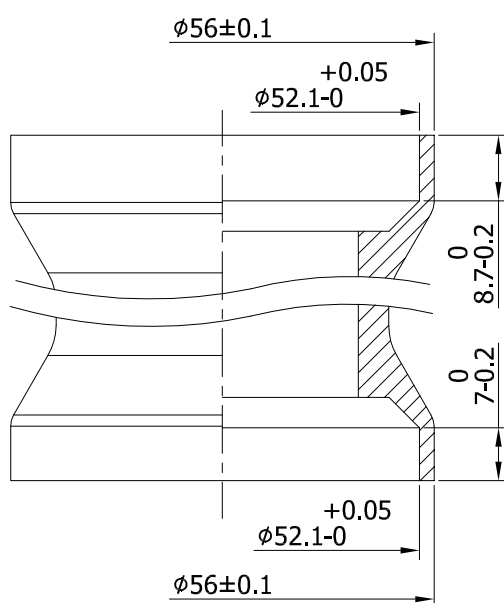
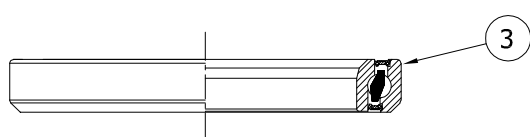
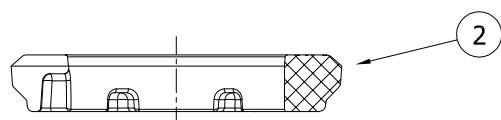
CABLE BOX Headset Bearing Kit



SHIS code: IS52/28.6 | IS52/40

No.	Item	Material	Drawing	Q'ty
1	Seal	NBR	TK155-1	1
2	Compression Ring	Composite	TK155-3	1
3	Premium Bearing	Steel	ACB52H7/4	1
4	Premium Bearing	Steel	TK52H65	1

Unit: mm

Scale: 1:1

 Revision: A
2021.12.16

TK1556-KIT

CABLE BOX Headset Bearing Kit with Crown Race

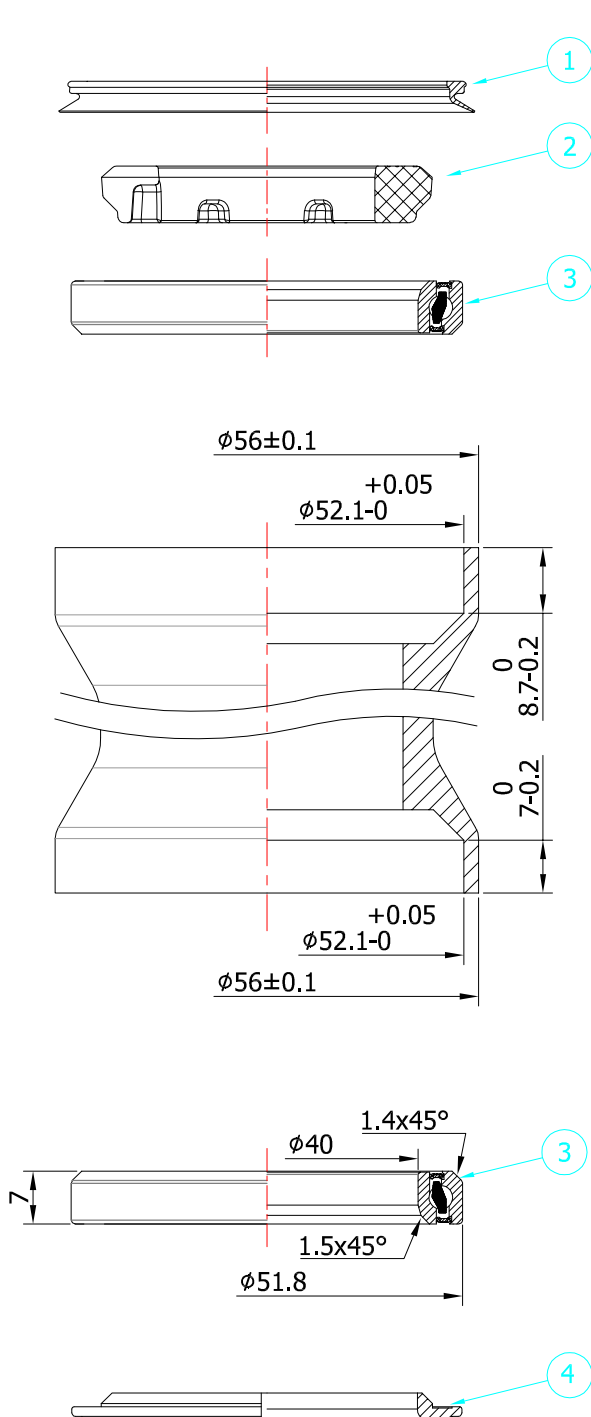

2

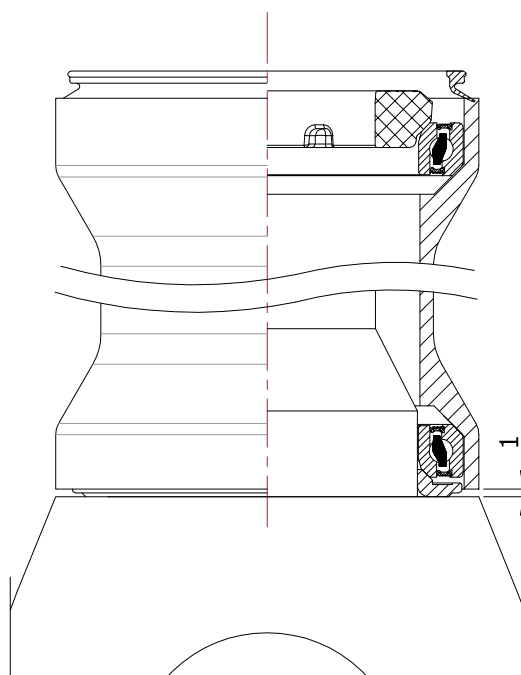
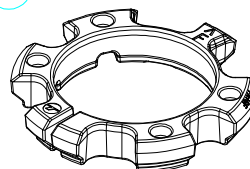

SHIS code: IS52/28.6 | IS52/40

No.	Item	Material	Drawing	Q'ty
1	Seal	NBR	TK155-1	1
2	Compression Ring	Composite	TK155-3	1
3	Premium Bearing	Steel	ACB52H7/4	2
4	Crown Race	Alloy	TK1556-6	1

Unit: mm

Scale: 1:1

 Revision: D
2021.11.24

**TK1566
TK1566P**

A-Box Headset w/ Carbon Top Cover, Alloy Cups and Crown Race
(TK1566P: With ① GF-Composite Top Cover TK155-2)

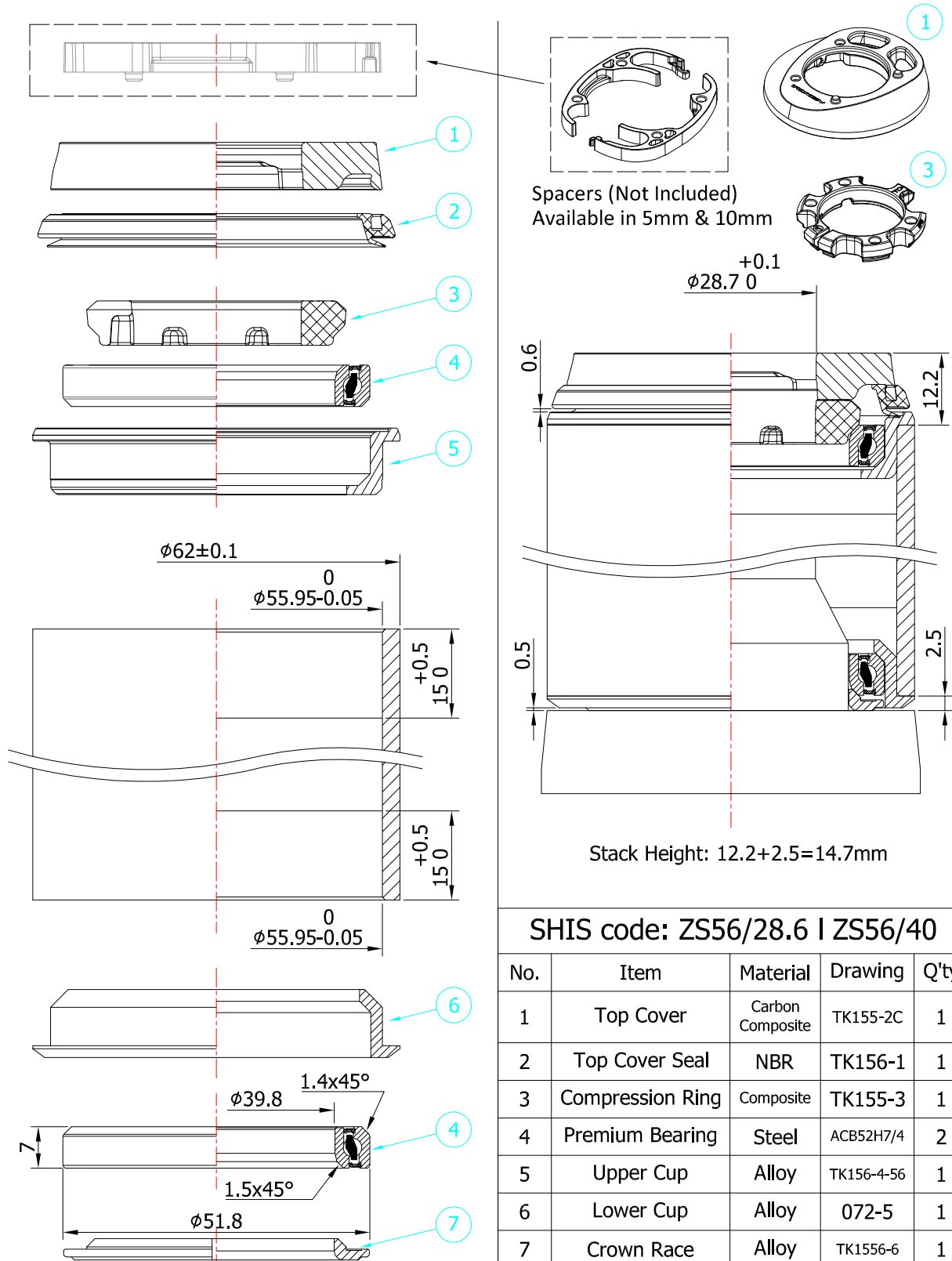

No.	Item	Material	Drawing	Q'ty
1	Top Cover	Carbon Composite	TK155-2C	1
2	Top Cover Seal	NBR	TK156-1	1
3	Compression Ring	Composite	TK155-3	1
4	Premium Bearing	Steel	ACB52H7/4	2
5	Upper Cup	Alloy	TK156-4-56	1
6	Lower Cup	Alloy	072-5	1
7	Crown Race	Alloy	TK1556-6	1

Unit: mm

Scale: 1:1

Revision: B
2021.11.24

TK1536
TK1536P

A-Box Headset w/ Carbon Top Cover

(TK1536P: With ① GF-Composite Top Cover TK155-2)

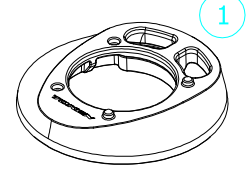
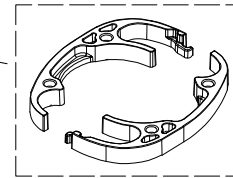
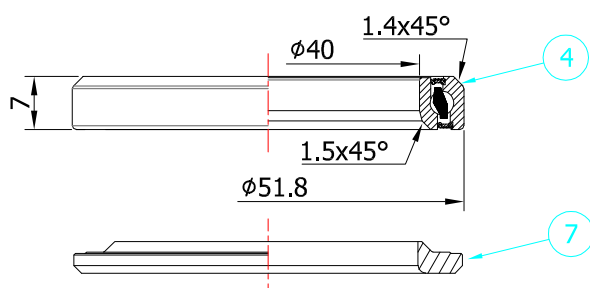
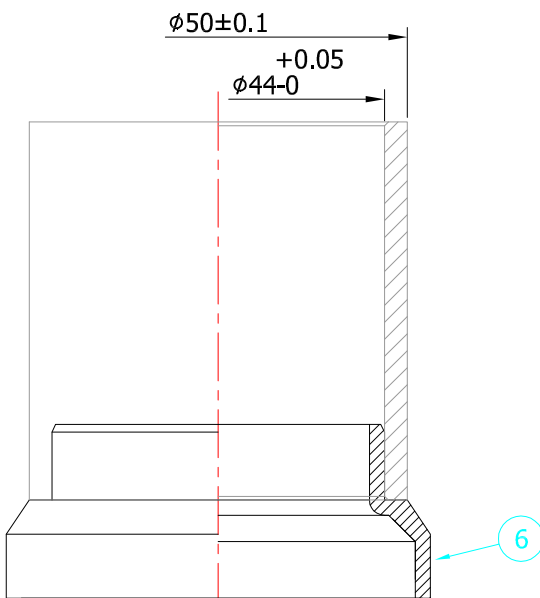
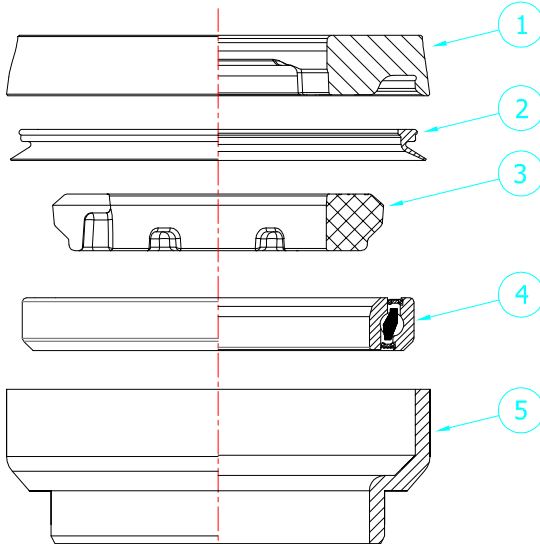
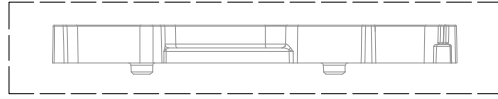

Spacers (Not Included)
Available in 5mm & 10mm

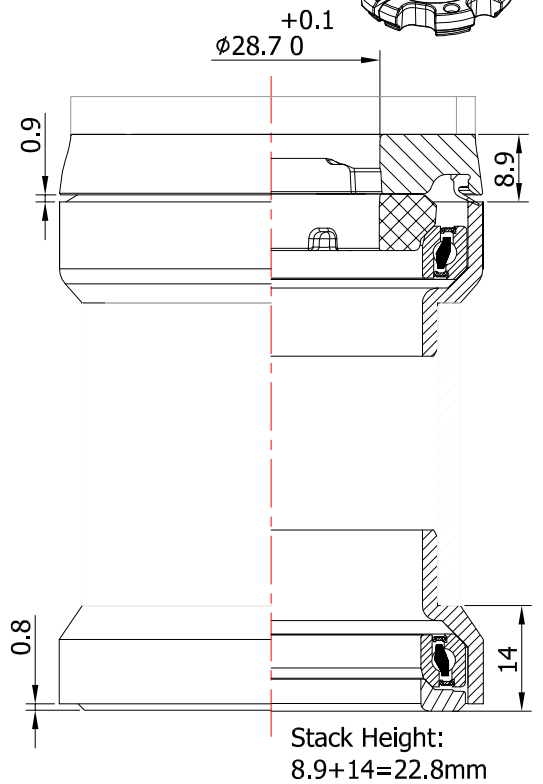
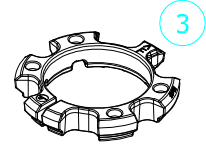

SHIS code: EC44/28.6 | EC44/40

No.	Item	Material	Drawing	Q'ty
1	Top Cover	Carbon Composite	TK155-2C	1
2	Top Cover Seal	NBR	TK155-1	1
3	Compression Ring	Composite	TK155-3	1
4	Premium Bearing	Steel	ACB52H7/4	2
5	Upper External Cup	Alloy	TK1536-4	1
6	Lower External Cup	Alloy	036T-5	1
7	Crown Race	Alloy	072-6/2	1

Unit: mm

Scale: 1:1

Revision: B
2021.11.24

TK1537
TK1537P

A-Box Headset w/ Carbon Top Cover

(TK1537P: With ① GF-Composite Top Cover TK155-2)

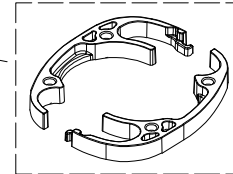
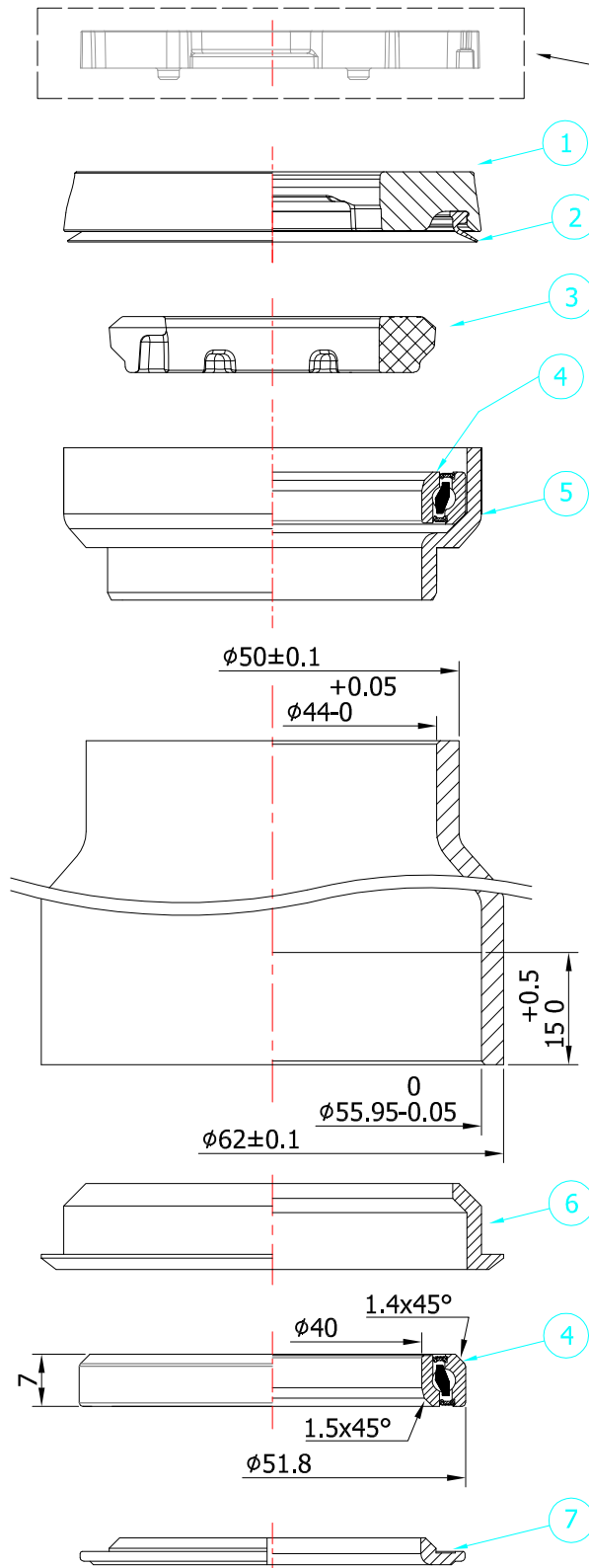
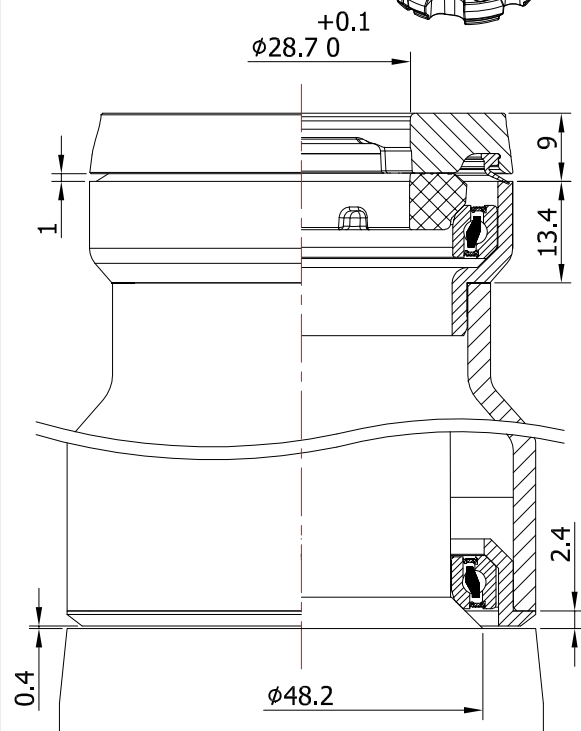
Spacers (Not Included)
Available in 5mm & 10mm

Stack Height: 8.9+2.4+13.4=24.7mm

SHIS code: EC44/28.6 | ZS56/40

No.	Item	Material	Drawing	Q'ty
1	Top Cover	Carbon Composite	TK155-2C	1
2	Seal	NBR	TK155-1	1
3	Compression Ring	Composite	TK155-3	1
4	Premium Bearing	Steel	ACB52H7/4	2
5	Upper External Cup	Alloy	TK1536-4	1
6	Lower Cup	Alloy	072-5	1
7	Crown Race	Alloy	TK1556-6	1

Unit: mm

Scale: 1:1

Revision: A
2021.12.27

TK155ZM

A-Box Headset w/ Customized Composite Top Cover

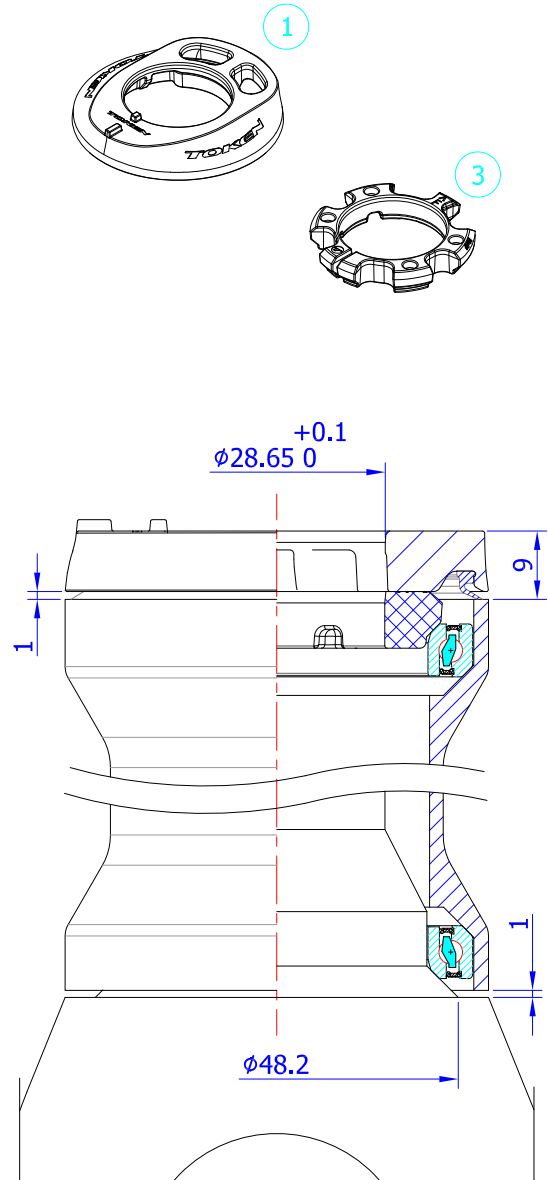
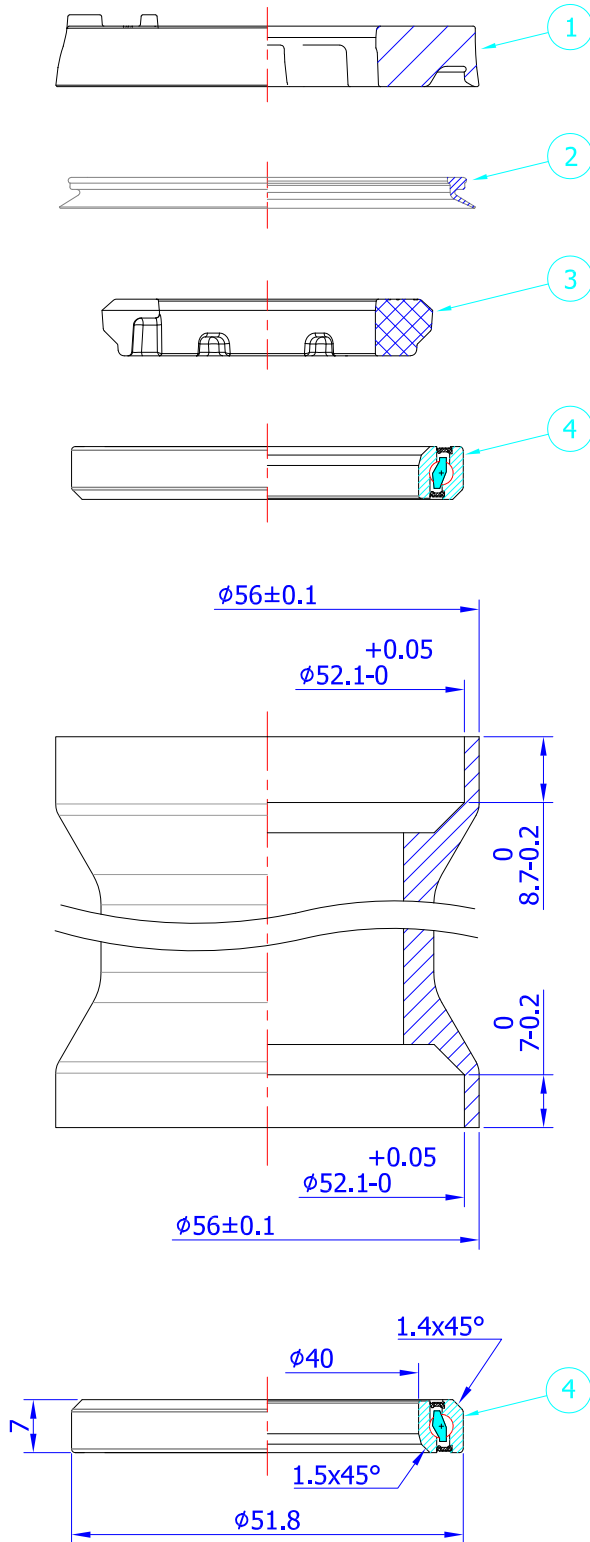

Stack Height: $9 + 1 = 10\text{mm}$

SHIS code: IS52/28.6 | IS52/40

No.	Item	Material	Drawing	Q'ty
1	Top Cover	Composite	TK155ZM-2	1
2	Seal	NBR	TK155-1	1
3	Compression Ring	Composite	TK155-3	1
4	Premium Bearing	Steel	ACB52H7/4	2
Unit: mm		Scale: 1:1	Revision: A	
			2022.09.23	

HEADSET TECHNICAL MANUAL

TK155ZM-36

A-Box Headset w/ Proprietary Interface of ZOOM Corp.
w/ 45° / 36° Lower Bearing

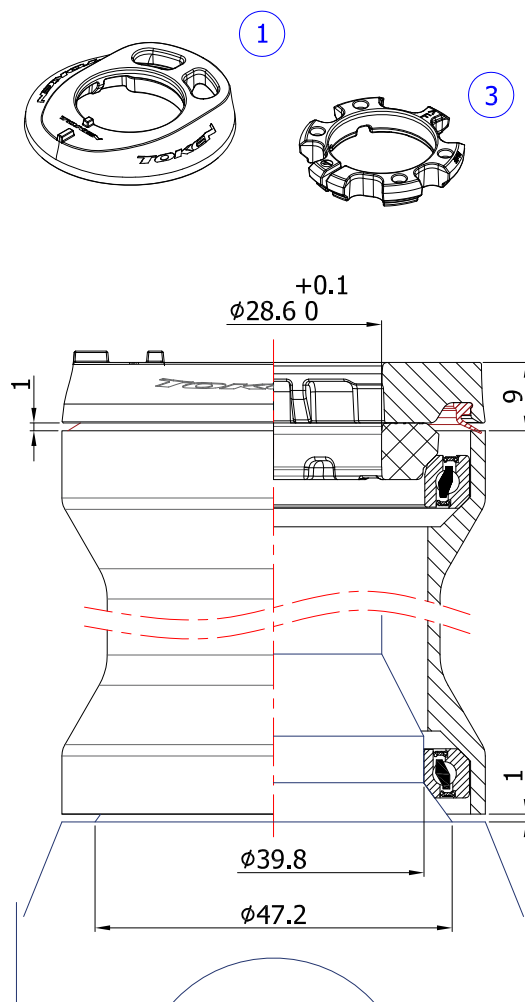
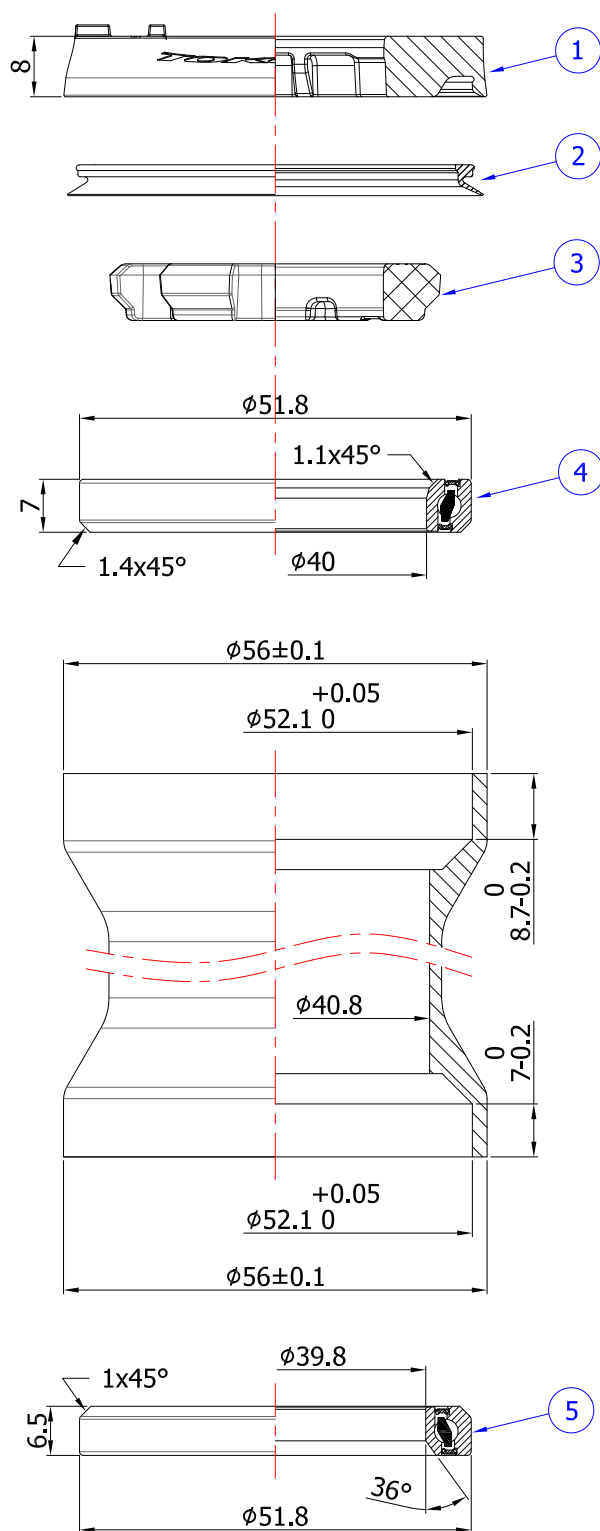

Stack Height: $9+1=10\text{mm}$

SHIS code: IS52/28.6 | IS52/40

No.	Item	Material	Drawing	Q'ty
1	Top Cover	Composite	TK155ZM-2	1
2	Seal	NBR	TK155-1	1
3	Compression Ring	Composite	TK155-3	1
4	Premium Bearing	Steel	ACB52H7/4	1
5	Premium Bearing	Steel	TK518H65	1

Unit: mm

Scale: 1:1

Revision: A
2023.01.04

TK1556ZM

A-Box Headset w/ Customized Composite Top Cover

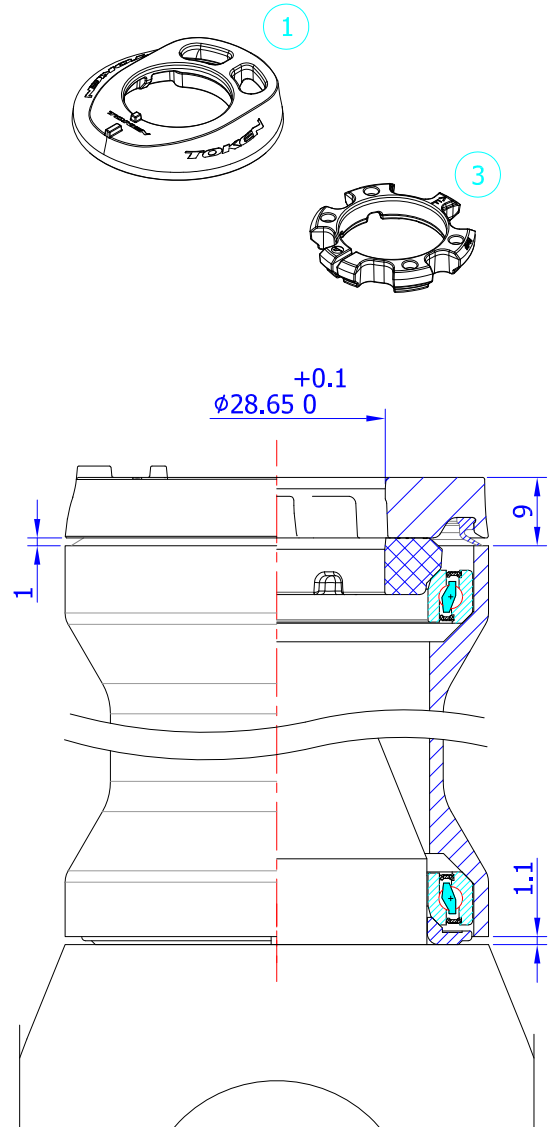
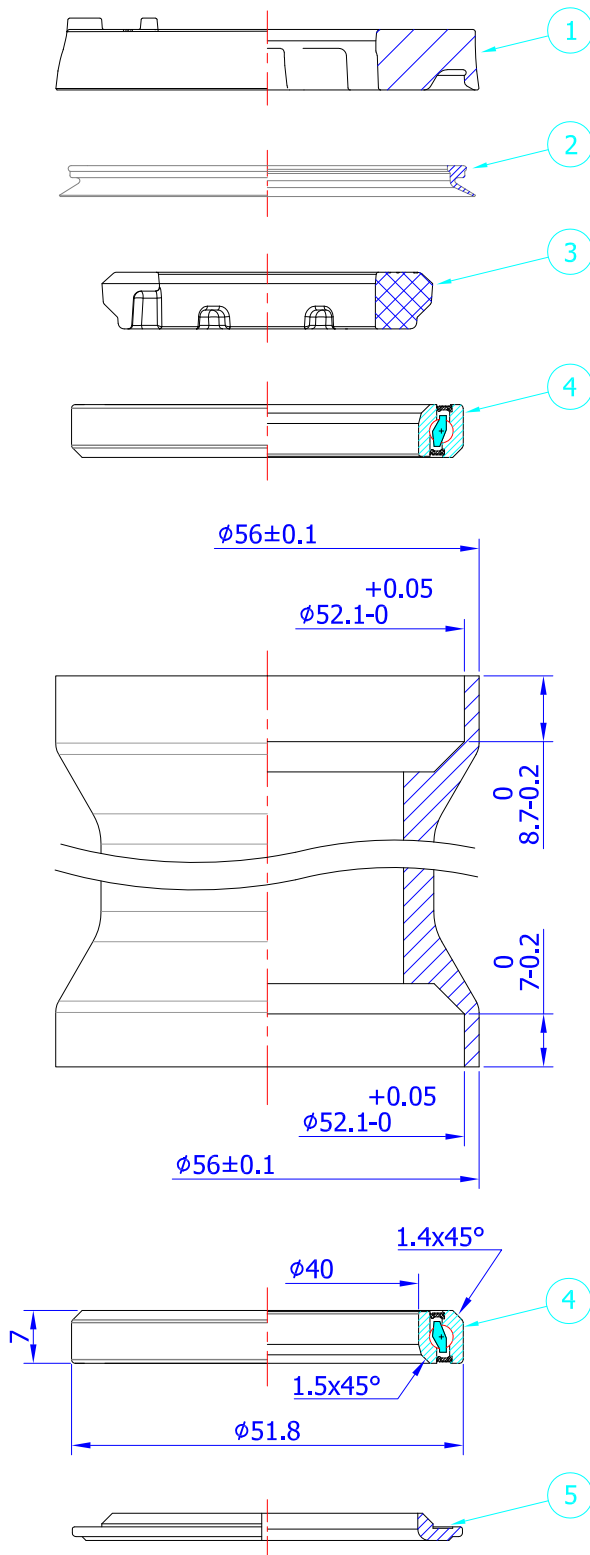

Stack Height: 9+1.1=10.1mm

SHIS code: IS52/28.6 | IS52/40

No.	Item	Material	Drawing	Q'ty
1	Top Cover	Composite	TK155ZM-2	1
2	Seal	NBR	TK155-1	1
3	Compression Ring	Composite	TK155-3	1
4	Premium Bearing	Steel	ACB52H7/4	2
5	Crown Race	Alloy	TK1556-6	1
Unit: mm		Scale: 1:1		Revision: A
				2022.09.30

TK1536ZM

A-Box Headset w/ Proprietary Interface of ZOOM Corp.

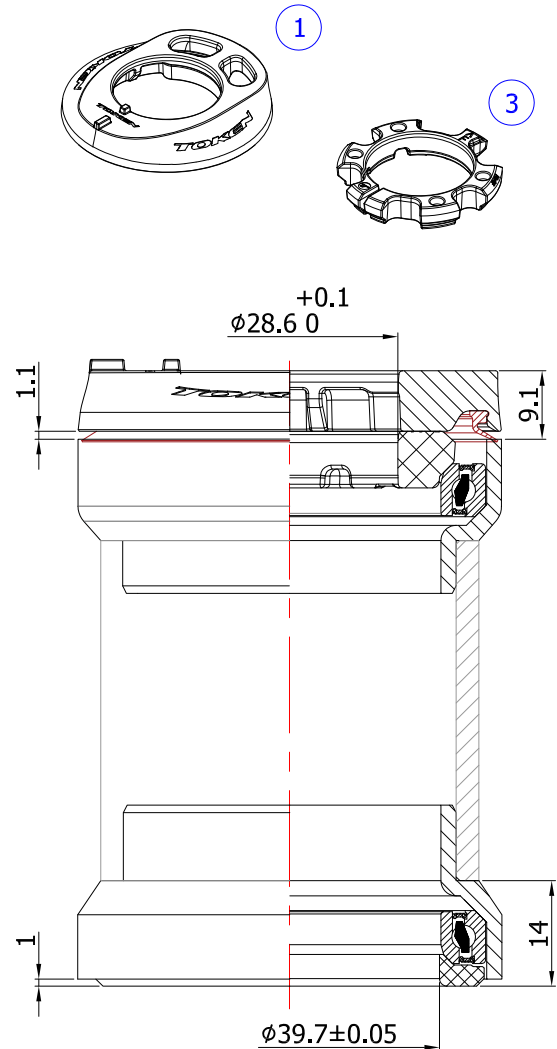
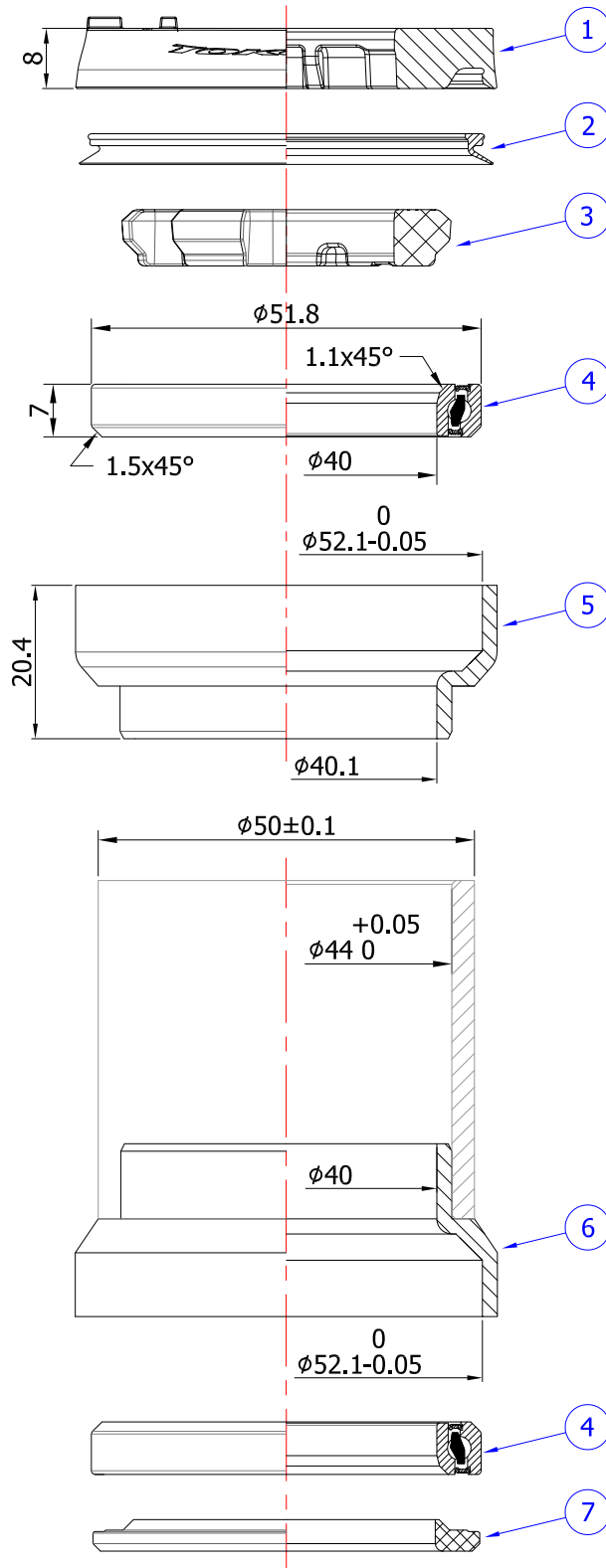

Stack Height: 9.1+14=23.1mm

SHIS code: EC44/28.6 | EC44/40

No.	Item	Material	Drawing	Q'ty
1	Top Cover	PA+GF	TK153ZM-2	1
2	Top Cover Seal	NBR	TK155-1	1
3	Compression Ring	Composite	TK155-3	1
4	Premium Bearing	Steel	ACB52H7/4	2
5	Upper External Cup	Alloy	TK1536-4	1
6	Lower External Cup	Alloy	036T-5	1
7	Crown Race	Alloy	072-6/2	1

Unit: mm

Scale: 1:1

Revision: A
2023.01.04

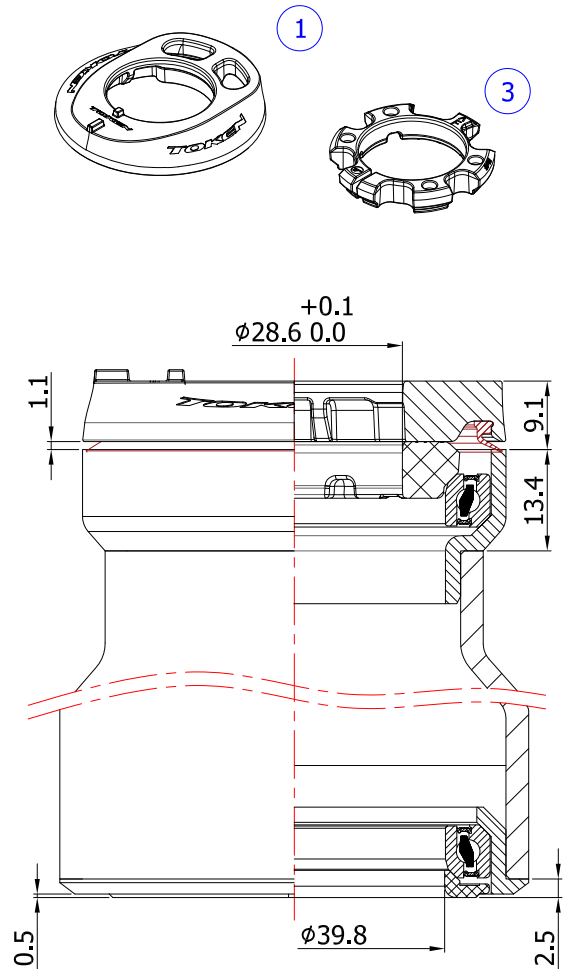
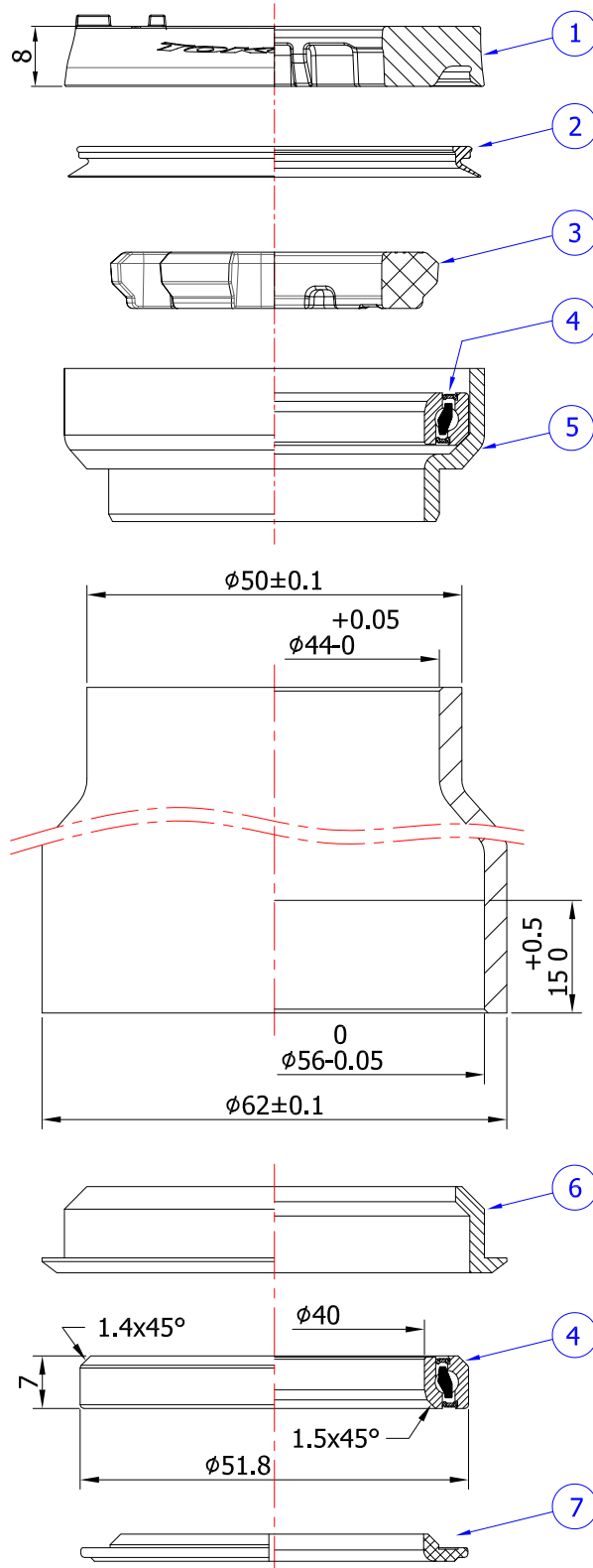
TK1537ZM
A-Box Headset w/ Proprietary Interface of ZOOM Corp.

Stack Height: 9.1+13.4+2.5=25mm

SHIS code: EC44/28.6 | ZS56/40

No.	Item	Material	Drawing	Q'ty
1	Top Cover	Composite	TK155ZM-2	1
2	Seal	NBR	TK155-1	1
3	Compression Ring	Composite	TK155-3	1
4	Premium Bearing	Steel	ACB52H7/4	2
5	Upper External Cup	Alloy	TK1536-4	1
6	Lower Cup	Alloy	072-5	1
7	Crown Race	Alloy	TK1556-6	1
Unit: mm		Scale: 1:1		Revision: A
				2023.01.04